

Automatic Edgebander

with chain feeding system

E 550



PURE Glueing unit (opt.)



Glueing unit **PURE**

It is possible to process material either with polyurethane (**PUR**) or **EVA** glue

- with PUR glue it is possible to stop the machine for a few days (up to 4), no cleaning is required.
- manual loading of hot melt adhesive granules (pot capacity 0,5 Kg)
Automatic cleaning cycle of the glue spreader roller
- Quick and easy glue pot cleaning
- Interchangeable glue pot
- Thermal regulation with automatic standby during processing pauses, which can be set on two different temperatures in respect to the glue being used.



Pre-milling with diamond cutterblocks Ø 60 h 52 mm with 2 extractor hoods Ø 80 mm

- Feed guide with micrometric adjustment 0 ÷ 2.0 mm
- HF motors 2 x 0.75 kW 12.000 rpm
- Max milling adjustment of 2 mm with panel heights 8–50 mm



Corner rounding unit for finishing corners on straight and shaped panels

- Maximum processing quality thanks to accurate machining with a double linear support guide and a diamond cutterblocks
- Possibility of processing panels up to a height of 45 mm and edges up to 3 mm in thickness
- Unit controlled by PLC, with the possibility of choosing whether to process all corners or only front ones or only rear ones.

GENERAL TECHNICAL DATA		
Feed speed	m/min	9
Panel thickness	mm	min 8 – max 50
Edge thickness in coils or strips	mm	min 0,4 – max 3
Edge thickness in strips (manual feeding)	mm	min 3 – max 5
Maximum coil diameter	mm	800
Space between panels	mm	600
Minimum panel length (Side being processed)	mm	110
Minimum panel width	mm	95
Maximum opening of front extensible support with small rollers for large panels	mm	500
Compressed air operating pressure	bar	6,5
Compressed air consumption during operation	nl/min	300
Dust extraction outlet connections	mm	1x Ø 120 + 2x Ø 80
Minimum airflow at dust extraction outlets	m/sec	20
Air consumption of dust extraction system	m ³ /min	1550
PRE-MILLING UNIT (PM version)		
Max milling with panel heights 8–50 mm	mm	2
HF motor power	kW	2 x 0,75
Tool dimensions of Diamond cutterblocks	mm	Ø 60 x H52
Tool rotation speed	rpm	12000
GLUEING UNIT		
Heating elements power (6 cartridges)	W	1.490
Heating time from ambient temperature	min.	14 – 16
Heating time from standby	min.	4 – 6
Glue pot capacity (PURE optional)	kg	1 (0,5)
END TRIMMING UNIT		
HF motor power	kW	0,22
End trimming unit blade dimensions	mm	2 x Ø 100, Z20
Blade rotation speed	rpm	12.000
FLUSH TRIMMING UNIT		
Motor power	kW	2 x 0.37
Tool rotation speed	rpm	12.000
Vertical copiers	2	discs Ø 120
Frontal copiers	2	pads
Tool dimensions with Widia disposable knives with combined profile	mm	2 x Ø75 x H20, Z4
CORNER ROUNDING UNIT (CR version)		
Motor power	kW	0,22
Tool rotation speed	rpm	12000
Vertical/horizontal copier	1	disc Ø50
Front copier	1	Stainless steel ring pad
Minimum panel thickness	mm	8
Maximum panel thickness	mm	45
Minimum panel length	mm	200
Tool radius	mm	2
EDGEBAND SCRAPER UNIT (optional)		
Vertical copiers	2	discs Ø 88
Frontal copiers	2	pads
Tool radius	mm	2 / 3
BUFFING UNIT (optional)		
Motor power	kW	2 x 0,13
Rotation speed	rpm	1.400
Brush dimensions	mm	2 x Ø 120

General Features

Logic functioning controlled by PLC

Complete with:

- Thermostatic glue control with automatic standby and temperature indicator
- Light-up LED buttons to select machine operating units
- Complete automation control of the various operating units from the encoder located on the transmission system for panel feeding
- Diagnostics system with messages for machine use and maintenance
- Statistical operating data: total hours of machine use, total and partial metres of edge used

Panel feeding system featuring a chain with rubber pads for maximum adherence to panels mounted on a strong steel chain with 5/8" links.

Two numerical controlled steel guides on machine frame guarantee the rubber pads to run both in straight line and have maximum stiffness on side push.

Top pressure bar with a double row of rubber rollers installed on bearings.

The height of the pressure bar can be adjusted by means of a handwheel, according to the thickness of the panel being processed, and it is fitted with a metric scale height indicator.

Pre-milling with diamond cutterblocks (PM version)

Mills the side of the panel where edge has to be applied to obtain a perfect straight glueing line without imperfections.

The unit is complete with waste extraction system and a blower to clean the side of the milled panel before the glueing phase.

Feeding fence with micrometric adjustment

Variable milling from 0 to 2.0 mm, adjustable with a knob and numerical indicator.

Pneumatic shear for cutting edge coils up to 3 mm.

- **Oscillatory movement** of the cutting shear unit

The oscillatory movement of the cutting shear unit ensures that the edge feeding is not interrupted during coil cutting, guaranteeing perfect glueing for edges up to a thickness of 3 mm and a panel height of 50 mm.

EDGE FEEDING

Teflon-coated glue pot to permit complete and rapid cleaning.

Fitted with 6 electrical heating elements (4 in the glue pot, 1 in the turret and 1 inside the glue spreading roller) to guarantee uniform glue temperature, eliminating the risk of excessive temperatures damaging the glue, which would prevent perfect glueing results.

The motorized spreading roller distributes a uniform layer of glue that can be adjusted in thickness on the side of the panel to be processed.

N. 2 pressure rollers: 1st diameter 80 mm in aluminium – 2 nd one is in rubber

Automatic Front/rear End Trimming unit – single motor (straight cut) with copying pads and collector hood

4 position Flush Trimming unit equipped with multi radius tools to switch easily from workmanships between thin edges, 1 or 2 mm thicknesses and solid strips.

Flush Trimmers with Z4 Ø 75 mm cutterblocks, Widia disposable knives with multiradius combined profile: straight/radius 1 mm/radius 2 mm- bevel 1.5° (radius 3 mm on request)

Flush Trimmers with vertical copier disc Ø 120 mm and front copying pads

Corner rounding unit (CR version) with Z4 Ø 50 mm diamond cutterblocks with 2 mm radius profile.

Unit fixed to the machine frame crossbeam with a double linear guide.

Front copying pad with stainless steel ring

Vertical/horizontal copier with 50 mm diameter disc.

Processing profiles with corner rounding unit

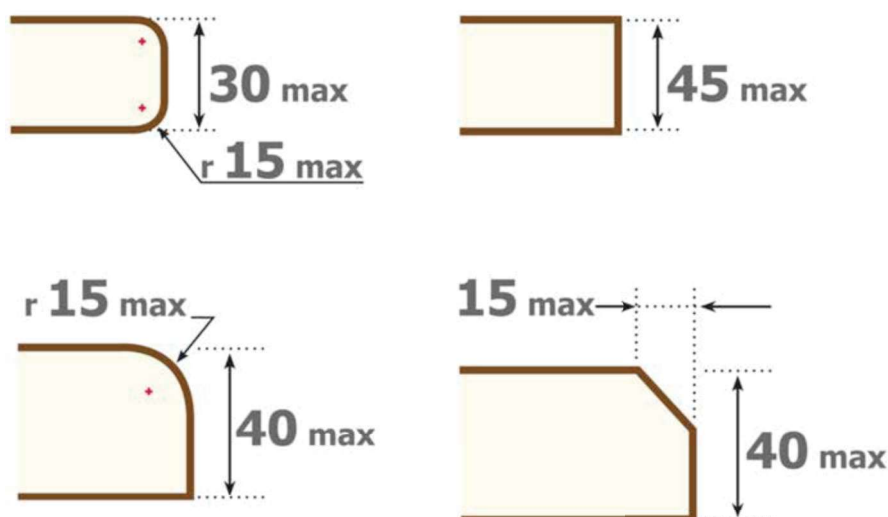

Front extensible support with small rollers for large panels

Rear plexiglass closure, to view inside operating units, which can be opened.

Composition E550

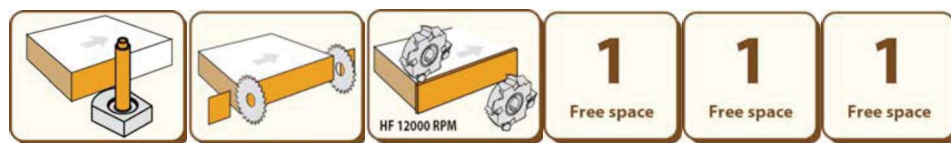

Composition E550 PM

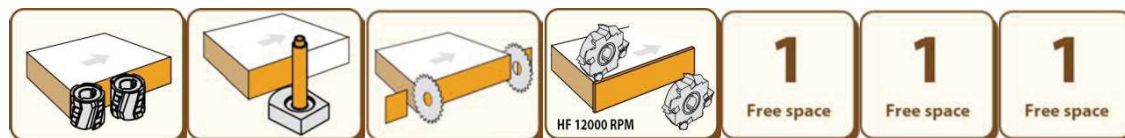

Composition E550 CR



Composition E550 PM CR

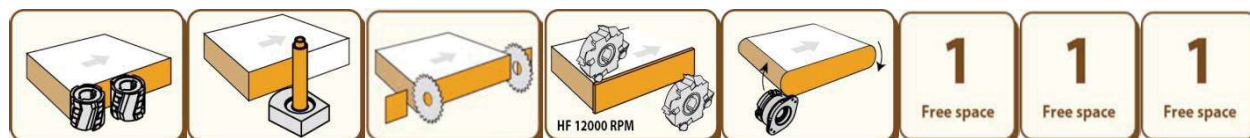

Options for free spaces

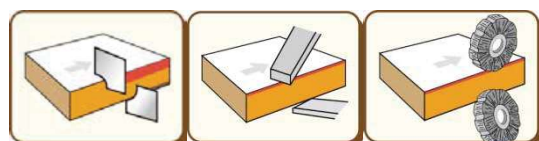

Options without occupying free spaces

